

MATERIAL :- BRASS
ALLOY :-
TREATMENT :- DULL TIN PLATING
B CODE :- 78
B APPROVAL SIGN:- APD
ADDITIONAL REQUIREMENTS :- N/A
ROHS REQUIRED :- YES
DESIGN DATE:- 13.11.14

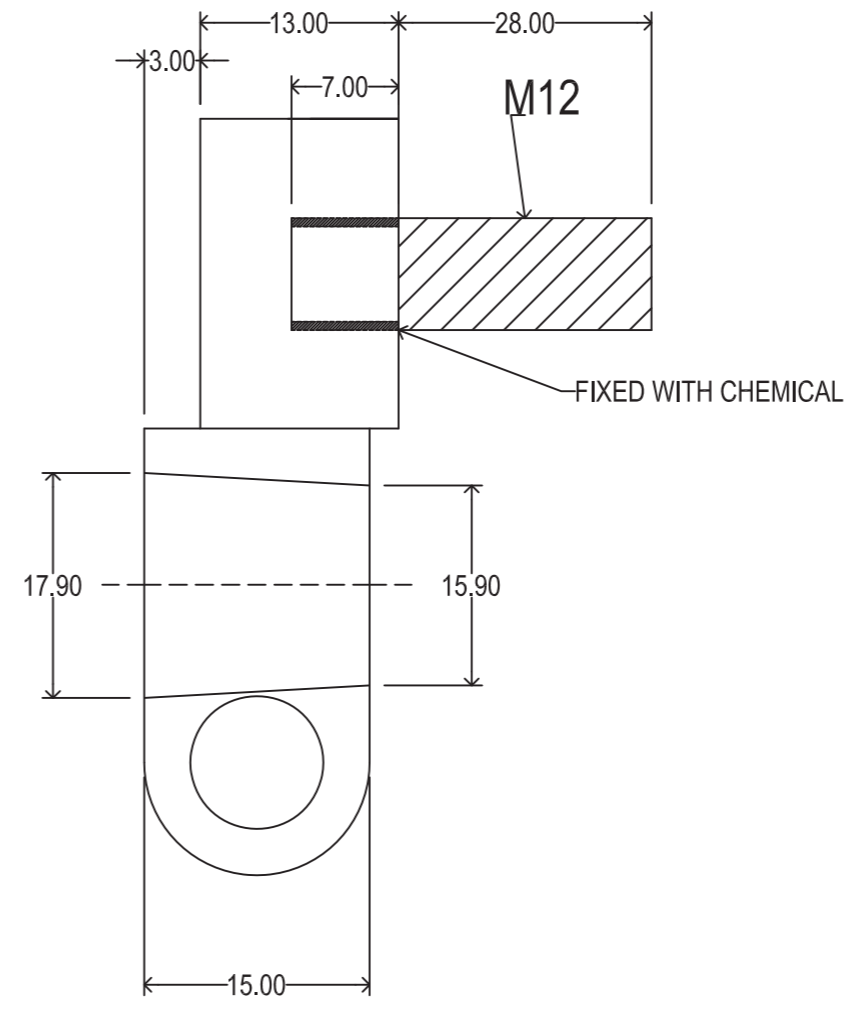
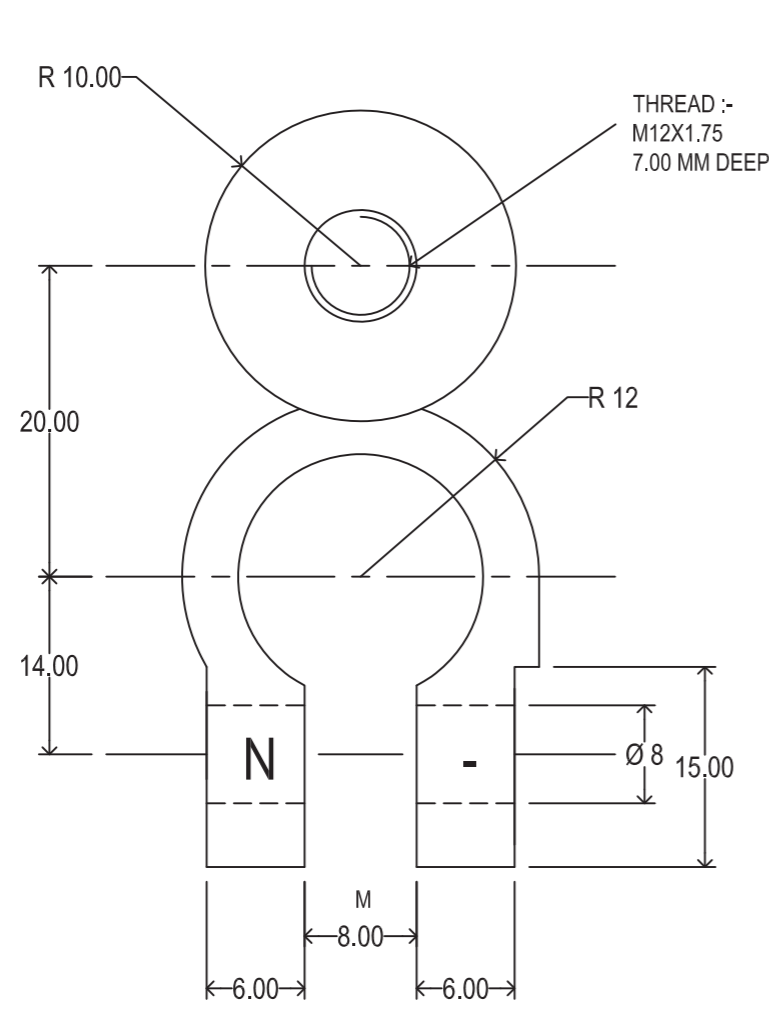

**FASTNER DETAIL**

- 1) 1PCS - M8X30<sup>mm</sup> SHAPE BOLT
- 2) 1PCS - M8 NUT
- 3) 1PCS - M12X35 BOLT (W/O HEAD)
- 4) 1PCS - M12 NUT
- 5) 1PCS - M12 DISK PLATE

**PLATING DETAIL**

- 1) FASTNER :- DULL TIN
- 2) TERMINAL :- DULL TIN

**SIZE :- 22.00 ROUND**  
**WEIGHT :- 115 g**  
**DIE BOX NO. :- 24**

PERMISSIBLE DEVIATIONS IN MM FOR RANGES IN NOMINAL LENGTHS			PERMISSIBLE DEVIATIONS IN MM FOR RANGES IN MINUTES FOR RANGES IN NOMINAL LENGTHS			PERMISSIBLE DEVIATIONS IN MM FOR RANGES IN NOMINAL LENGTHS			PERMISSIBLE DEVIATIONS IN MM FOR RANGES IN NOMINAL LENGTHS			PERMISSIBLE DEVIATIONS IN MM FOR RANGES IN NOMINAL LENGTHS								
EXTERNAL RADIUS CHAMFER HEIGHT			LINEAR AND DIAMETRAL DIMENSIONS			ANGULAR DIMENSIONS LENGTH OF SHORTER SIZE			EXTERNAL RADIUS CHAMFER HEIGHT			LINEAR AND DIAMETRAL DIMENSIONS			ANGULAR DIMENSIONS LENGTH OF SHORTER SIZE					
0.0196	0.1191	0.2382	0.0118	0.2785	1.2204	4.7637	0.00	0.4330	2.0076	0.50	3.00	6.00	0.30	7.00	31.00	121.00	0.00	11.00	51.00	
0.1191	0.2382	0.3573	0.2382	1.1611	4.7244	1.9685	4.7244	1.9685	3.00	6.00	10.00	6.00	30.00	120.00	10.00	50.00	120.00			
±0.0078	±0.0196	±0.0393	±0.0039	±0.0078	±0.0118	±0.0196	±0.1°	±0.0°30'	±0.0°20'	±0.20	±0.50	±1.00	±0.10	±0.20	±0.30	±0.50	±1.1°	±0.0°30'	±0.0°20'	

**GENERAL NOTES & TOLERANCE AS PER ISO 2768 - 1 1989**  
 1. UNLESS OTHERWISE STATED, ALL DIMENSIONS ARE IN INCHES.  
 2. REMOVE ALL BURRS AND SHARP EDGES.  
 3. TOLERANCE FOR DIMENSIONS.  
 4. CLASS OF DEVIATIONS :- MEDIUM  
 5. BELOW TOLERANCE ARE FOR TURN COMPONENTS. DO NOT USE THIS TOLERANCE ON CAST PRODUCT, OR FORGED PRODUCT.  
 6. FOR CRITICAL / IMPORTANT DIMENSION USE ELLIPSES SIGN.  
 7. MULTIPLY INCHES X 25.4 = MILLIMETER (MM)

**GENERAL NOTES & TOLERANCE AS PER ISO 2768 - 1 1989**  
 1. UNLESS OTHERWISE STATED, ALL DIMENSIONS ARE IN MM.  
 2. REMOVE ALL BURRS AND SHARP EDGES.  
 3. TOLERANCE FOR DIMENSIONS.  
 4. CLASS OF DEVIATIONS :- MEDIUM  
 5. BELOW TOLERANCE ARE FOR TURN COMPONENTS. DO NOT USE THIS TOLERANCE ON CAST PRODUCT, OR FORGED PRODUCT.  
 6. FOR CRITICAL / IMPORTANT DIMENSION USE ELLIPSES SIGN.  
 7. MULTIPLY MILLIMETERS (MM) X 0.03937 = INCHES  
 8. DIVIDE MILLIMETERS BY 25.4 = INCHES

<b>Battery terminal with M12 thread negative D</b> 		Material:	Units: mm	Article number: 68061400 Tolerances: linear ±0.2mm Angular ±0.5°
		Scale: 1:1	Checked:	
		Drawn: hFd	Date: 14/10/15	A3
				Drawing: 10000010593_00